

Castlemaine Market Building



Quick Facts

The Information Centre in this restored 1860's market building acts as the hub for the Diggings trail. You can start exploring from here.

The Market Building is in Mostyn Street, in central Castlemaine.

Car parking and disabled access is at the rear (Forest Street entrance). It is a ten minute walk from the Castlemaine

Railway Station.

Access: By car, bus or train

Period: 1860's to the present

Time: Allow 30 minutes

Stories: people, a town booms

Ceres, the Roman goddess of the harvest, stands above the entrance to this building: a symbol of fruitfulness and abundance.

The Castlemaine Market Building opened to great fanfare in 1862. At the time, it formed the axis of a market complex with a wing extending from each side. In the 1860's Castlemaine had the highest Chinese population of any goldfield in Victoria and many of them had become market gardeners.

The building quickly became very much the centre of activity in the town, and not just for commercial purposes.

Today this beautiful building acts as a Visitor Information Centre, and houses special exhibitions and other events. There is also a state of the art visual presentation of the the goldfields and the attractions of this region.

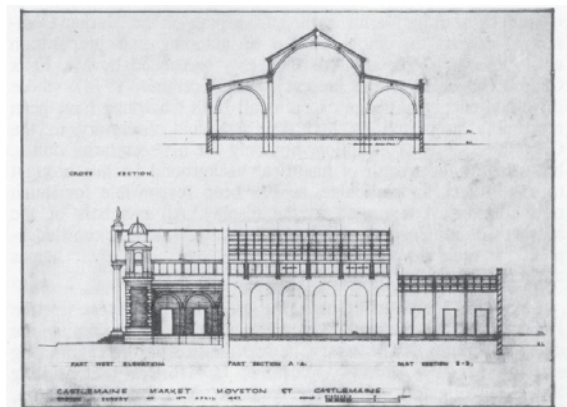

The design by Town Surveyor, Mr W B Downe

'It seems incredible that I was in a new country; that within half of my own life all this had been a wilderness... I thought of... Midas reversed - not wholesome things turned to gold, but gold transmuted into earth's choicest treasures.'

- English writer and historian, J.A Froude, 1885,
on visiting the central Victorian goldfields.